

Permittee: Trace and Katherina Marlow

1. This Development Variance Permit is issued subject to compliance with all RDEK bylaws applicable thereto, except as specifically varied or supplemented by this Permit.
2. This Permit applies to and only to those lands described below:

Lot 17, District Lot 10352, Kootenay District Plan 7892
[PID: 010-403-051]
3. Regional District of East Kootenay – Electoral Area C South Zoning & Floodplain Management Bylaw No. 2913, 2019, Section 1.08 (2)(a) which requires a home based business to be conducted wholly within a dwelling unit or accessory building, with no external storage of materials, containers or finished product, and no exterior evidence of the home based business, is varied permit the temporary external placement of up to three boats in association with a home based business.
4. The lands described herein shall be developed strictly in accordance with the terms and conditions of this Permit and in substantial compliance with the development variance permit application received on November 21, 2019.
5. This Permit shall come into force on the date of an authorizing resolution passed by the RDEK.
6. This Permit is not a building permit.
7. If development authorized by this Permit does not commence within two years of the issue date of this Permit, the Permit shall lapse.
8. A notice pursuant to Section 503(1) of the *Local Government Act* shall be filed in the Land Title Office and the Registrar shall make a note of the filing against the title of the land affected.
9. It is understood and agreed that the RDEK has made no representations, covenants, warranties, guarantees, promises, or agreement (verbal or otherwise) with the developer other than those in this Permit.
10. This Permit shall inure to the benefit of and be binding upon the parties hereto and their respective heirs, executors, administrators, successors, and assigns.

Authorizing Resolution No. **adopted by the Board of the Regional District of East Kootenay on the** **day of** **, 2020.**

Shannon Moskal
Corporate Officer

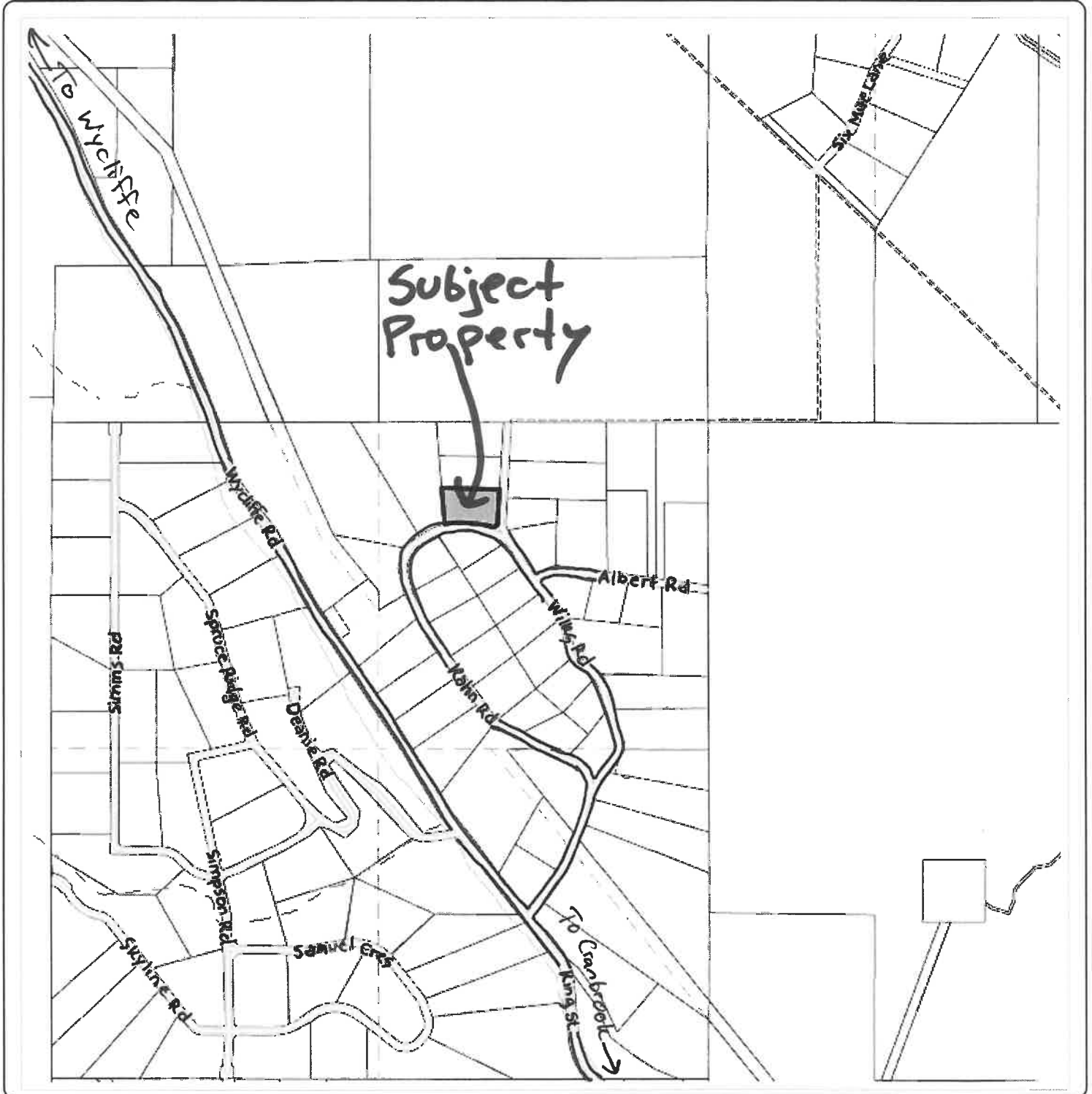

Notes:

500 0 250 500 Meters

WGS_1984_Web_Mercator_Auxiliary_Sphere
RDEK GeoViewer - 11-1-2019 12:01 PM

Scale = 1: 20,000



THIS MAP IS NOT TO BE USED FOR NAVIGATION

This map is a user generated static output from an Internet mapping site and is for reference only. Data layers that appear on this map may or may not be accurate, current, or otherwise reliable.

Land Use Map



Notes:

125 0 63 125 Meters

WGS_1984_Web_Mercator_Auxiliary_Sphere
RDEK GeoViewer - 11-1-2019 12:02 PM

Scale = 1: 5,000



THIS MAP IS NOT TO BE USED FOR NAVIGATION

This map is a user generated static output from an Internet mapping site and is for reference only. Data layers that appear on this map may or may not be accurate, current, or otherwise reliable.

Site Plan

