

Location Map

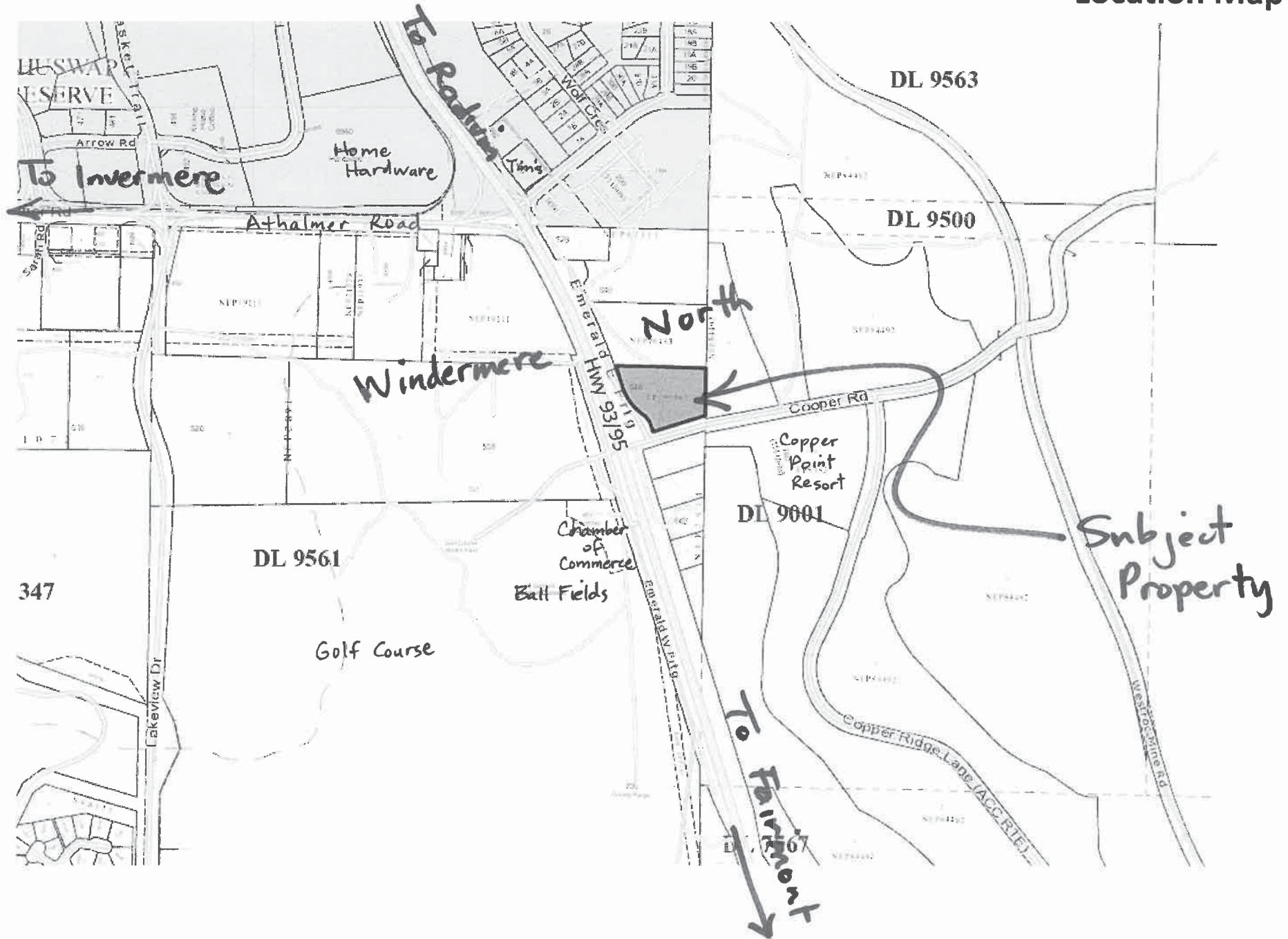

19_ESSO_P22624_P01_R6

S:\1_CORP CUSTOMERS\ESSO\Projects\P22624 Invermere\03-Design\Art

DRAWING APPROVAL: _____
INVERMERE_ESSO_PYLON_REV6



Ph. 250.489.3321 Fax 250.426.8852
 421 Patterson St.W., Cranbrook, B.C. V1C 6T3
 www.selkirksigns.com



Page: 1 of 1

Description
 New non illuminated two pole pylon

Quantity 1

Scale
 100%

Revisions
 #5
 Date: 12/9/19
 Details: Non illuminated - CN
 #6
 Date: 12/10/19
 Details: Crossroads to replace C-Store - CN

- Single Sided
- Double Sided
- Draft
- Concept Only
- Shop Ready

Client Approval

Signature: _____

Date: _____

© Selkirk Signs & Services Ltd.
 This design is the sole property of Selkirk Signs & Services Ltd. and may not be used, or duplicated in any form without the express written permission of Selkirk Signs & Services Ltd.

Perspective renditions in this drawing are by the designer. Only approximate sizes and perspectives of the signs are being achieved.

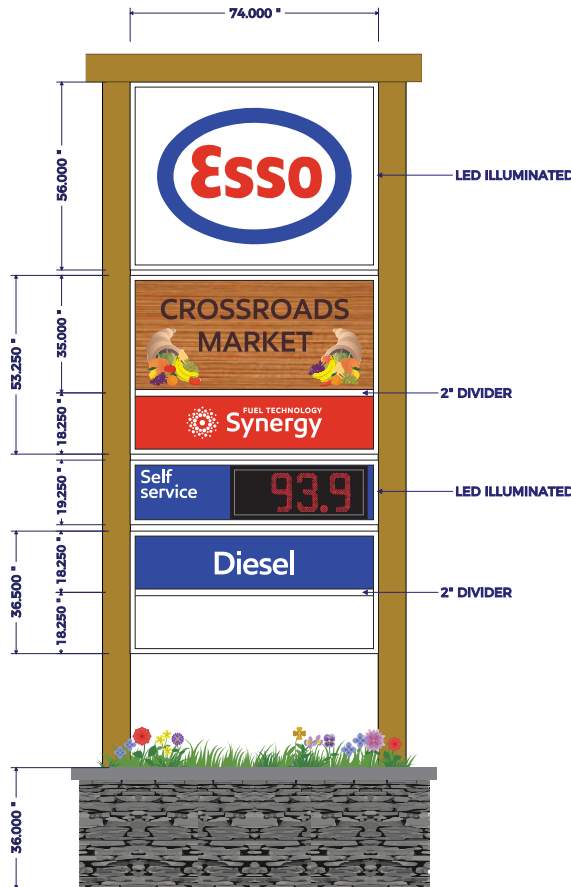

ALL FACES ARE NON ILLUMINATED EXCEPT ESSO / PRICER

CUSTOMER: ESSO ADDRESS: 9480 JUNIPER HEIGHTS RD, INVERMERE PROJECT MANAGER: PATRICIA WHALEN DESIGNER: CN DATE: 7/ 4/ 19

CONSTRUCTION: PYLON FACES
ILLUMINATION: ESSO / PRICER ILLUMINATED ONLY
FRAME: WHITE EX7 FRAME W/ 2" DIVIDERS
SUBSTRATE: 4.5MM CLEAR ACRYSTEEL
GRAPHICS: SECOND SURFACE VINYL
PRICER: NEW 12" RED WIRELESS HYOCO
 PRICER C/W ULTRA-DISTANCE RECEIVER

VINYL COLOURS:
 3630-20 WHITE VINYL
 3630-33 RED VINYL
 3630-97 BRISTOL BLUE VINYL