

Permittee: Darlene Middlecoat and Carl Schur

1. This Temporary Use Permit, notwithstanding any zoning bylaw, allows the temporary use on Lot 8, District Lot 138, Kootenay District, Plan 8296 (PID 013-295-861) in strict accordance with the terms and conditions herein.
2. The temporary use allowed by this Permit is to permit placement and residential use of a recreational vehicle with deck and an accessory shed structure prior to the principal dwelling being constructed.
3. The use of part of the subject property shall be in substantial compliance with information provided in the Temporary Use Permit application received July 9, 2024.
4. This Permit shall expire twelve (12) months from the date of issuance. Renewal of this permit will not be considered unless a building permit for a single family dwelling is issued.
5. This Permit is subject to compliance with all provincial legislation.
6. It is understood and agreed that this Permit does not imply approval for future rezoning to permit the structure.
7. It is understood and agreed that the RDEK has made no representations, covenants, warranties, guarantees, promises, or agreement (verbal or otherwise) with the property owner other than those in this Permit.
8. The development allowed by this permit is subject to all other RDEK Bylaws.

**Authorizing Resolution No. _____ adopted by the Board of the Regional District of East
Kootenay on the _____ day of _____, 2024.**

**Tina Hlushak
Corporate Officer**

Location Map



Notes:

450 0 225 450 Meters

Scale = 1: 18,000



THIS MAP IS NOT TO BE USED FOR NAVIGATION

Land Use Map

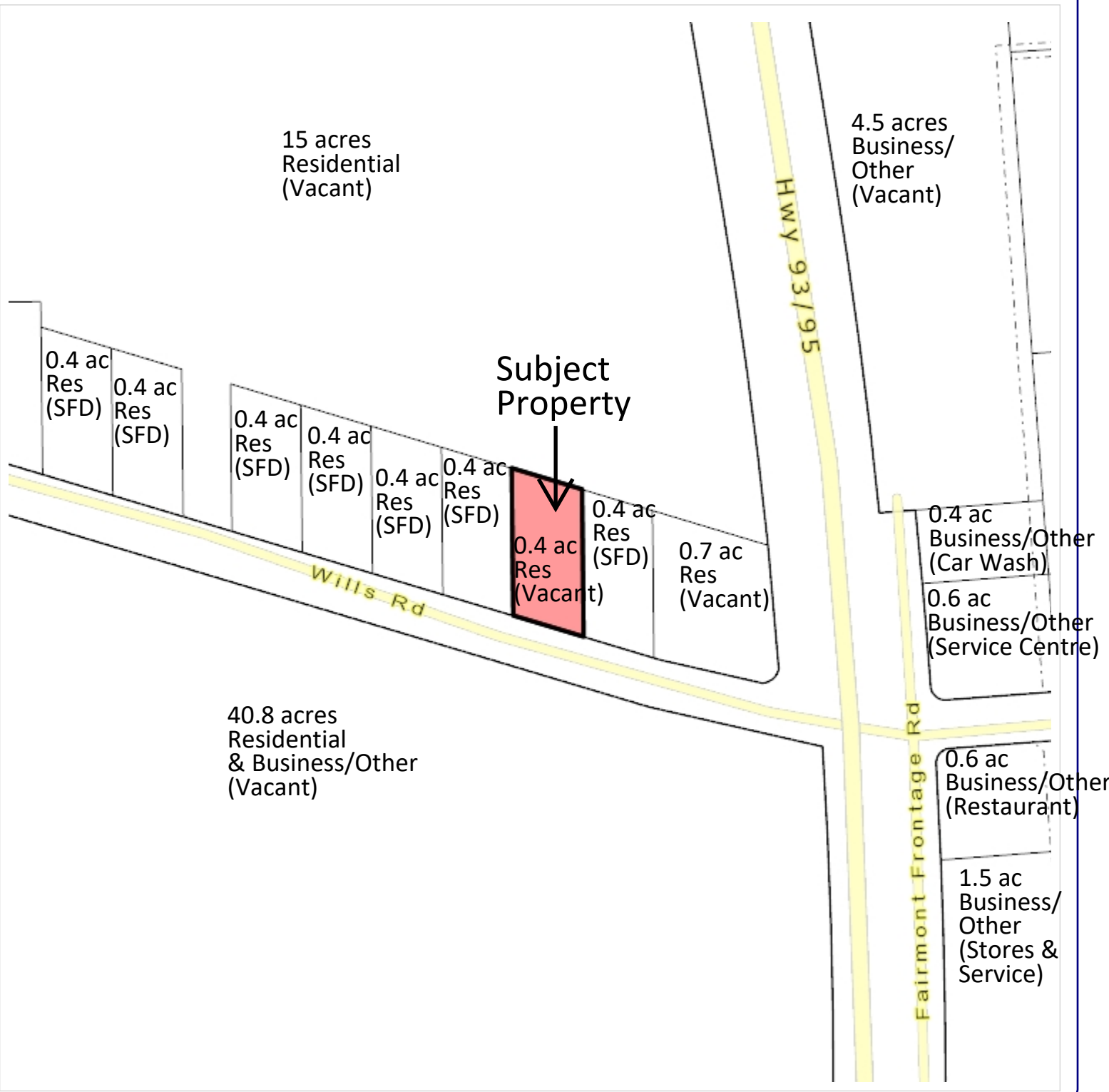

Notes:

88 0 44 88 Meters

WGS_1984_Web_Mercator_Auxiliary_Sphere
RDEK GeoViewer - 8-19-2024 8:50 AM

Scale = 1: 3,500



THIS MAP IS NOT TO BE USED FOR NAVIGATION

This map is a user generated static output from an Internet mapping site and is for reference only. Data layers that appear on this map may or may not be accurate, current, or otherwise reliable.

Zone Designation Map

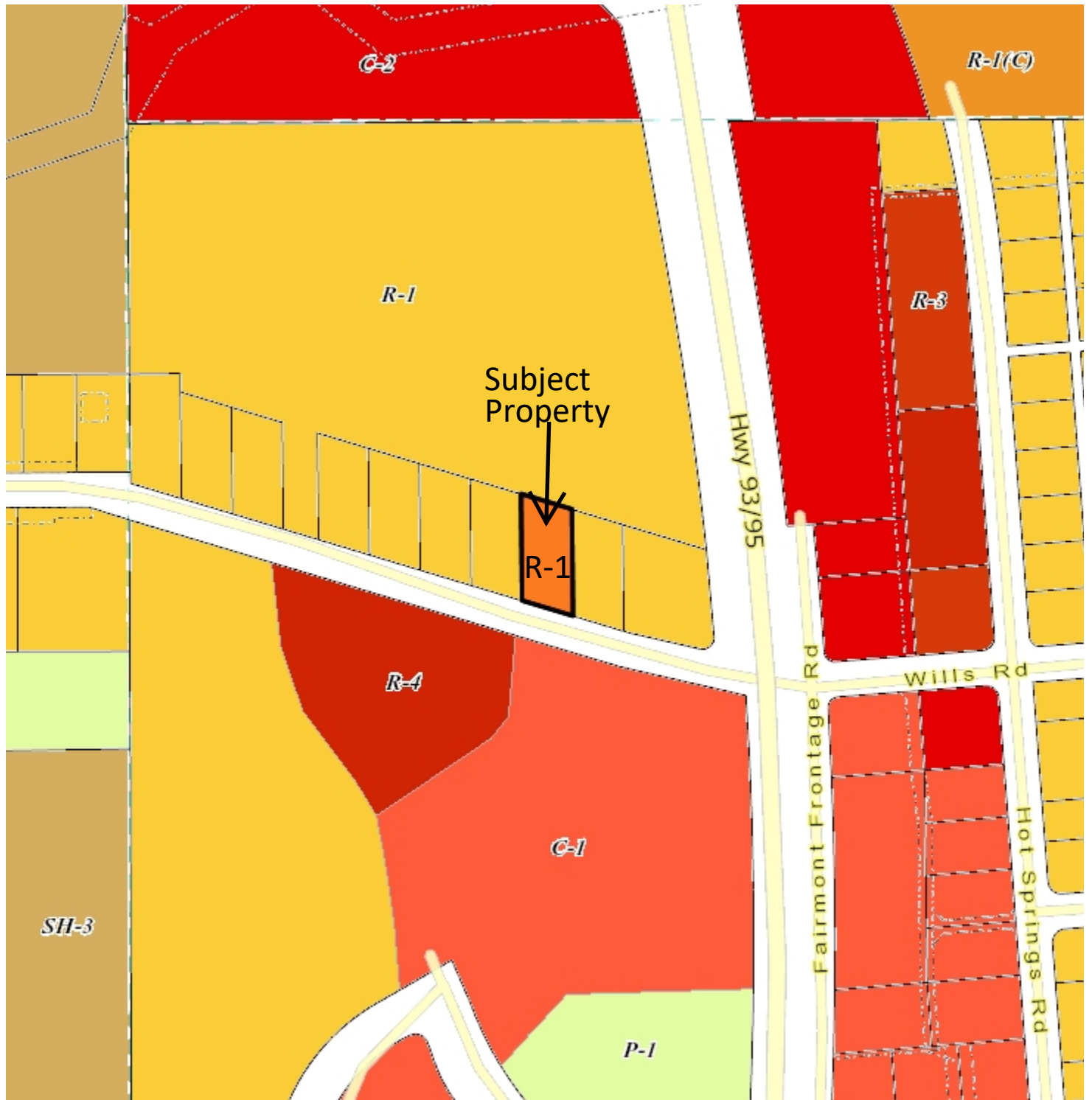

Notes:



Scale = 1 : 5,000



THIS MAP IS NOT TO BE USED FOR NAVIGATION

Site Photos

Existing Structures:



Picture of property from the Road:





Notes:

63 0 31 63 Meters

WGS_1984_Web_Mercator_Auxiliary_Sphere
RDEK GeoViewer - 8-19-2024 8:56 AM

Scale = 1:2,500



THIS MAP IS NOT TO BE USED FOR NAVIGATION

This map is a user generated static output from an Internet mapping site and is for reference only. Data layers that appear on this map may or may not be accurate, current, or otherwise reliable.